

90° FLAT EDGE SQUARES

- DIN875 grade 0
- Made of hardened stainless steel

Part No.	Size (LxW)	Squareness		C	D	H
		Inside (α)	Outside (β)			
4791-50	2.0x1.6"	236 μ in	236 μ in	.591"	.591"	.157"
4791-75	3.0x2.0"	236 μ in	276 μ in	.591"	.591"	.157"
4791-100	3.9x2.8"	276 μ in	276 μ in	.787"	.787"	.197"
4791-150	5.9x3.9"	276 μ in	315 μ in	1.181"	1.181"	.236"
4791-200	7.9x5.1"	315 μ in	354 μ in	1.181"	1.181"	.276"
4791-250	9.8x6.5"	354 μ in	394 μ in	1.378"	1.378"	.276"
4791-300	11.8x7.9"	394 μ in	433 μ in	1.575"	1.575"	.315"



4791-100

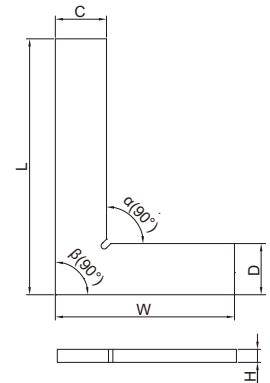

90° FLAT EDGE SQUARES WITH WIDE BASE

- DIN875 grade 0
- Made of hardened stainless steel

Part No.	Size (LxW)	Squareness		C	D	H	E
		Inside (α)	Outside (β)				
4793-50	2.0x1.6"	236 μ in	236 μ in	.512"	.512"	.157"	.512"
4793-75	3.0x2.0"	236 μ in	276 μ in	.591"	.591"	.157"	.591"
4793-100	3.9x2.8"	276 μ in	276 μ in	.787"	.787"	.197"	.787"
4793-150	5.9x3.9"	276 μ in	315 μ in	1.181"	1.181"	.236"	1.181"
4793-200	7.9x5.1"	315 μ in	354 μ in	1.181"	1.181"	.276"	1.181"
4793-250	9.8x6.5"	354 μ in	394 μ in	1.378"	1.378"	.276"	1.378"
4793-300	11.8x7.9"	394 μ in	433 μ in	1.575"	1.575"	.315"	1.575"



4793-100

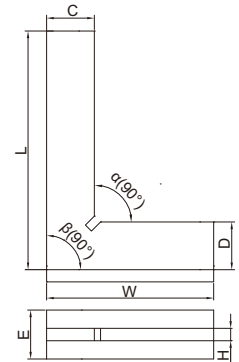

90° FLAT EDGE SQUARES WITH WIDE BASE

- DIN875 grade 0
- Made of hardened stainless steel

Part No.	Size (LxW)	Squareness		C	D	H	E
		Inside (α)	Outside (β)				
4792-50	2.0x1.6"	236 μ in	236 μ in	.472"	.472"	.118"	.394"
4792-75	3.0x2.0"	236 μ in	276 μ in	.551"	.551"	.118"	.394"
4792-100	3.9x2.8"	276 μ in	276 μ in	.709"	.709"	.118"	.394"
4792-150	5.9x3.9"	315 μ in	315 μ in	.866"	.866"	.157"	.472"
4792-200	7.9x5.1"	354 μ in	354 μ in	.984"	.984"	.157"	.472"



4792-100

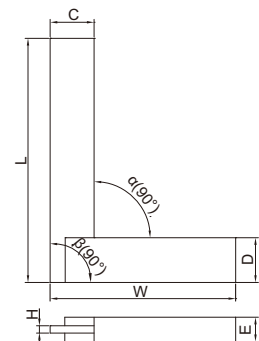

90° BEVELED EDGE SQUARES WITH WIDE BASE

- DIN875 grade 0
- Beveled edges for inside and outside measurement
- Made of hardened stainless steel

Part No.	Size (LxW)	Squareness		C	D	H	E
		Inside (α)	Outside (β)				
4795-50	2.0x1.6"	236 μ in	236 μ in	.472"	.472"	.118"	.394"
4795-75	3.0x2.0"	236 μ in	276 μ in	.551"	.551"	.118"	.394"
4795-100	3.9x2.8"	276 μ in	276 μ in	.709"	.709"	.118"	.394"
4795-150	5.9x3.9"	315 μ in	315 μ in	.866"	.866"	.157"	.472"
4795-200	7.9x5.1"	354 μ in	354 μ in	.984"	.984"	.157"	.472"



4795-100

